

For use with all CleanRead™ Luminometers.

CleanRead™ H2O Water and Solution ATP Detection Swabs



Item# 345AS2

Monitors ATP levels in water as a Quality Cleanliness Indicator with results in **only 15 Seconds!**

CleanRead™ H2O ATP devices are portable ATP tests used with handheld luminometers to check water cleanliness by measuring ATP levels. This includes ATP from both living microbes and non-microbial or dead microbes, important for healthcare settings, particularly for assessing the cleanliness of endoscopes and other medical devices with internal channels.

Features

- All-in-one sampling device.
- 13 month shelf life at refrigerated temperatures (36°F to 47°F) (2°C to 8°C) Check expiration date on label.
- 4 week shelf life at room temperatures (70°F) (21°C).
- Unique liquid-stable reagent.
- Tolerant to temperature abuse and sanitizers.

Here's how it works

The CleanRead™ Contamination Monitoring System detects Adenosine Triphosphate (ATP), the universal energy molecule found in all animal, plant, bacterial, yeast, and mold cells. Contamination contains ATP, but in smaller amounts. After cleaning, all sources of ATP should be significantly reduced.

When ATP is picked up by the tip of the H2O ATP Detection Swab and brought into contact with the unique, liquid stable luciferase/luciferin reagent in the H2O ATP Detection Swab tube, light is emitted in direct proportion to the amount of ATP present. The H2O ATP Detection Swab is then placed in the CleanRead™ Handheld unit where it measures the amount of Relative Light Units (RLU) generated and displays the level of contamination present in just 15 seconds. CleanRead™ Handheld unit will detect 1/100,000th dilution of blood, i.e. 0.2mg protein per swab. The handheld unit can then be synced to a PC where the reading is downloaded to an easy-to-use database management software for tracking the results. The software program can be used to run comparison charts and produce color trend analysis graphs and reports.

Unique liquid-stable reagent

Easy to activate
snap valve

Swab tube

Honeycomb-shaped dipper
accurately collects 100ul of
liquid for consistent sampling.



280 Duffy Avenue
Hicksville, NY 11801
Local: (516) 696-0822
Mail: orders@ebdny.com
Web: www.ebdny.com

Distributed by :



To reorder contact your Ruhof Sales Representative at :
1-800-537-8463
Web: www.ruhof.com

IFU-CR003-01 Rev 051925

Instructions / Directions For Use

Testing should be done after cleaning, prior to high-level disinfection or sterilization.*

On the homescreen, tap on Dashboard and navigate to Test points.

Look up for the test group that needs to be tested either by scrolling down the list of available test groups OR by typing in the search bar OR use the barcode/Rfid reader in the Dashboard. (Note: Barcodes and RFIDs need to be registered before use.) Select the desired test group, tap on the desired test point (red tag) and press 'Start'. Alternately you can switch to the List view to select the test points.

Allow H2O Swab test devices to equilibrate to room temperature (21-25°C) before use. Forcefully flick device in a downward motion to shake liquid extractant from collection dipper to bottom of tube. Shaking liquid extractant to bottom of tube assists with accurate extraction of ATP and helps collect a more consistent sample. Holding swab tube firmly, twist and pull collection device out of tube. Submerge sample collection dipper in water sample for 1-2 seconds.

Lift sample collection device up vertically and reinsert in test tube. Gently shake device for 1-2 seconds to release water sample from collection tip and to mix sample with extractant at bottom of test tube. Activate H2O ATP Swab by holding tube firmly and using thumb and forefinger to break SnapValve by bending bulb forward and backward. Squeeze bulb twice, expelling all liquid into tube. Shake for 3-5 seconds to mix sample.

Insert the ATP Swab tube into the CleanRead™ Handheld device, close and press the OK button. In 15 seconds the CleanRead™ Handheld will display the amount of contamination detected.

Close the lid and press **"OK"**. In 15 seconds the unit will prompt you to remove the swab.

After the swab is removed and the lid closed, the result shall be displayed on the screen. **Tap OK** to save the results.

The CleanRead™ hand held device will automatically sync to the web portal --via WiFi--for tracking results.

Safety & Precautions:

Components of H2O ATP Detection Swab do not pose any health risk when used correctly.

1. Check expiration date on label to be sure product is suitable for use.
2. Hold luminometer upright when measuring test devices.
3. Hold H2O ATP Swab test upright when activating.
4. Read H2O ATP Swab test within 15 seconds of activation.
5. Keep H2O ATP Swab test out of direct sunlight.

If you have a test failure please contact the manufacturer of the device being tested for advice on the best cleaning practice and products available that will help produce better outcomes.

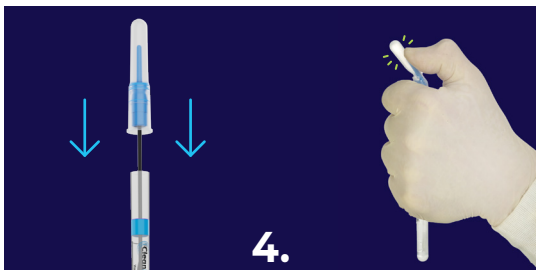
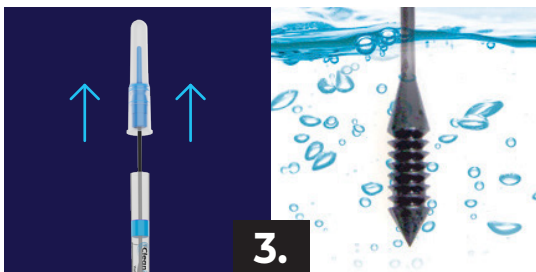

280 Duffy Avenue
Hicksville, NY 11801
Local: (516) 696-0822
Mail: orders@ebdny.com
Web: www.ebdny.com

Distributed by:



To reorder contact your Ruhof Sales Representative at:
1-800-537-8463
Web: www.ruhof.com