



CleanRead™-PRT Surface Protein Detection Swabs

Item# CR005

Measure protein contamination on any scope, cannulated instrument or surface in **10 minutes!**

Ensure the cleanliness of your facility with the CleanRead™ Surface Protein Detection Swab. This product is designed for the detection of protein residues on various surfaces including surgical instruments, scopes, washer-disinfectors, and in environments such as exam rooms, operating rooms, restrooms, and waiting areas. To use, simply swab the desired surface, release the reagent, and observe the color change. A purple color indicates the presence of protein residues, with the depth and speed of the color change reflecting the degree of contamination. Quick and easy to use, CleanRead™ provides a reliable method for monitoring surface cleanliness.

Features

- Delivers results within 1-10 minutes.
- All-in-one sampling device.
- Unique liquid-stable reagent.
- Features an easy-to-interpret color change, eliminating the need for instrumentation.
- Comes with a pre-moistened swab that ensures reliable sample collection, recovery, and detection for consistent outcomes.

Sensitivity

- Detects 80 µg protein after 30 seconds
- Detects 40 µg protein after 1 minutes
- Detects 20 µg protein after 2 minutes

Color results

			
Pass	Caution	Fail	Fail

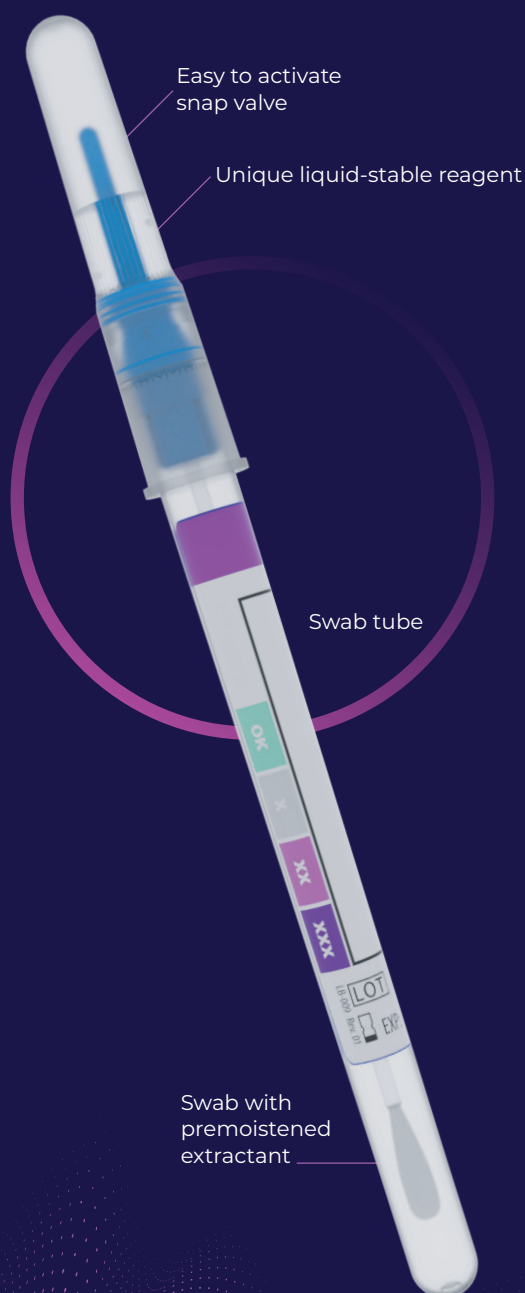

280 Duffy Avenue
Hicksville, NY 11801
Local: (516) 696-0822
Mail: orders@ebdny.com
Web: www.ebdny.com

Distributed by:



To reorder contact your Ruhof Sales Representative at:
1-800-537-8463
Web: www.ruhof.com

IFU-CR-005-01 Rev 051925

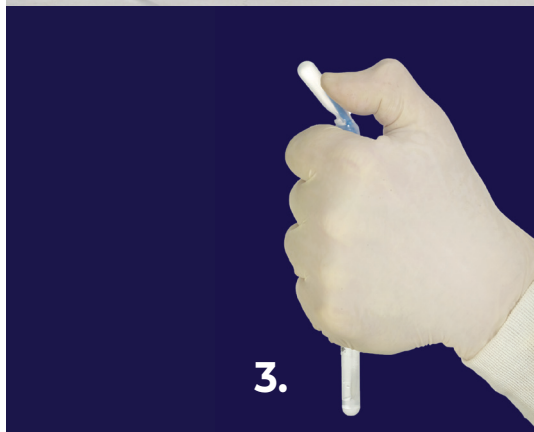
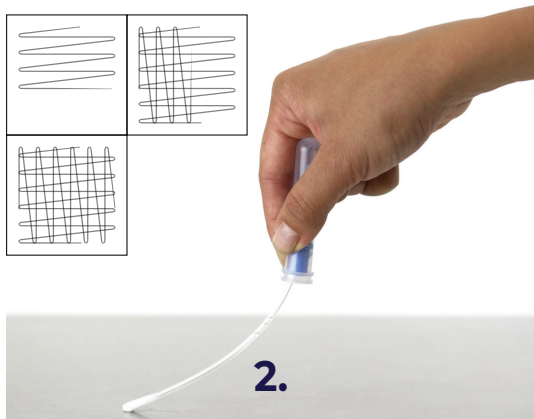
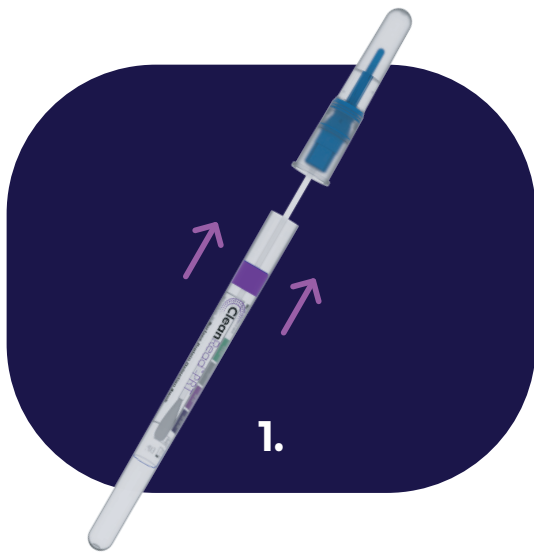

OK



Pass

X



Fail

Instructions For Use

CleanRead™-PRT Surface Protein Swabs are ready-to-use tests for detecting protein residues on surfaces after cleaning. These tests change color from green to purple when protein is present in a sample, with the intensity and speed of the change indicating the amount of protein detected. CleanRead™-PRT is designed to provide rapid validation of surface hygiene and demonstrate due diligence within an infection control program.

Before you begin...

- CleanRead™-PRT is engineered to detect trace or invisible amounts of residue. To ensure accuracy, avoid using the swab on surfaces that are visibly dirty, as overloading the swab with soil can inhibit the reaction and lead to inaccurate results.
- It is essential to wait an appropriate amount of time after sanitizing before testing a surface with CleanRead™-PRT devices. Sanitation typically involves a two-step process: cleaning with detergent followed by an optional disinfection step. For optimal results, collect the CleanRead™-PRT sample after the detergent and rinsing steps but prior to any terminal disinfection.
- The swab tip is pre-moistened to ensure maximum sample collection.
- Condensation inside the swab tube is normal and may be visible.

Procedure :

- Remove the Surface Protein Detection Swab from the tube by gripping the bulb and pulling gently.
- Using consistent downward pressure, swab a defined area (approximately 10 cm²) in a standardized pattern (e.g., horizontal and vertical strokes) to cover the surface adequately.
- Ensure the swab tip contacts all potential areas of contamination.
- Rotate the Surface Protein Detection Swab during sampling to ensure adequate loading of organic residues.
- When dealing with irregular surfaces, ensure that sampling covers a sufficient area uniformly, maintaining a consistent approach throughout.
- Immediately place the swab back into its sterile tube after sampling.
- To activate the test, hold the swab tube firmly and use the thumb to break the valve by applying pressure against the bulb wall—about half-way up--until the blue nib inside snaps. Squeeze the bulb to expel all the liquid down the swab shaft. Shake the tube for 5-10 seconds.
- Wait for 10 minutes, then compare the color of the reagent with the color chart on the tube label to determine the result. Color changes typically occur in less than 60 seconds.



280 Duffy Avenue
Hicksville, NY 11801
Local: (516) 696-0822
Mail: orders@ebdny.com
Web: www.ebdny.com

Distributed by :



To reorder contact your Ruhof Sales Representative at :
1-800-537-8463
Web: www.ruhof.com